

FORM B - Building

Massachusetts Historical Commission
Massachusetts Archives Building
220 Morrissey Boulevard
Boston, Massachusetts 02125

Map and Lot # 233 102 USGS Quad Area(s) Form Number 575

Town Groton3
Place (neighborhood or village)

Photograph

(3"x3" or 3-1/2x5" black and white only) Label photo on back with town and property address. Record film roll and negative numbers here on form. Staple photo to left side of form over this space. Attach additional photos to continuation sheets.

Roll Negative(s)

Address 79 Schoolhouse Road
Historic Name Gale House
Uses: Present Residential/agricultural
Original Residential/agricultural
Date of Construction c. 1890
Source Estimate

Style/Form Victorian Eclectic

Architect/Builder

Exterior Material:

Foundation Undetermined

Wall/Trim Wood clapboard

Roof Asphalt shingle

Outbuildings/secondary structure

Attached 19th c. barn

Major Alterations (with dates)

Some siding replaced, 2007

Condition Good

Moved no yes Date

Acreage 6.6

Setting Rural

Sketch Map

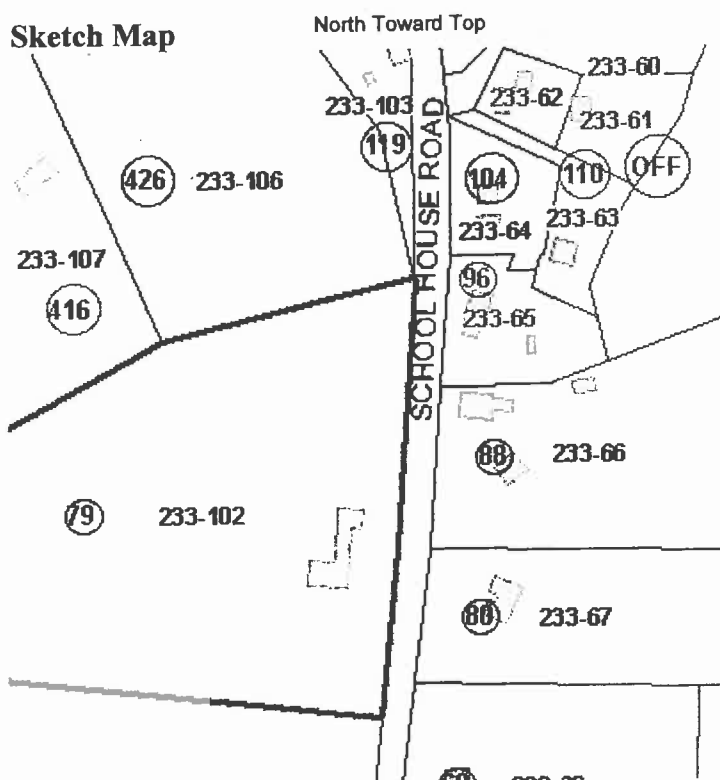

Recorded by Sanford Johnson

Organization Groton Historical Commission

Date (month/year) 12/08

Follow Massachusetts Historical Commission Survey Manual instructions for completing this form.

BUILDING FORM

ARCHITECTURAL DESCRIPTION

see continuation sheet

Describe architectural features. Evaluate the characteristics of this building in terms of other buildings within the community.

- * The Victorian Eclectic style farmhouse at 79 Schoolhouse Road is a front-gabled, 2x2-bay, 2 1/2-story form with a 1-story ell at the south side that connects to the front-gabled barn; a 1-story open porch covers the first story of the façade and the south elevation of the main block
- * Decorative features include the corner pilasters with molded caps, gable returns and molded cornice
- * Windows are 2/2 double hung sash with plain trim
- * The barn is banked with the south side of the foundation open at the ground level; the façade has a rolling vehicle door in the center and a single 6/6 sash in the gable peak; additional window openings have fixed 6-pane sash on the south elevation at both the first and second stories; decorative features are the gable returns that match those on the house and corner boards
- * The house and barn are well-maintained, occupy a rural setting and are typical in terms of scale and details for Groton farms; the barn continues to house horses

HISTORICAL NARRATIVE

see continuation sheets

Discuss the history of the building. Explain its associations with local (or state) history. Include uses of the building, and the role(s) the owners /occupants played within the community.

The house at 79 Schoolhouse Road does not appear on historic maps until the 1930 Groton map by Somes when it was depicted as the home of F. W. Gale. This is Frederick W. Gale, a laborer listed in the 1929 resident directory as living with his farmer parents Fred B. and Clemma Gale who had lived here since at least 1918. Schoolhouse Road was referred to at this time by some as Gale Road. After the destruction by fire of the Lawrence Academy schoolhouse in 1956, Fred W. Gale, employed as school carpenter, worked along with faculty members and union carpenters to build a temporary schoolhouse out of barracks that had been moved to the campus from Fort Devens near Ayer.

BIBLIOGRAPHY and/or REFERENCES

continuation sheet

1918, 1929 resident directories; 1930 Some map of Groton; Reminiscences of Richard Jeffers, archivist at Lawrence Academy; "Groton Houses", p. 36; "The History of Lawrence Academy at Groton 1792-1992", Doug Frank;

**** All properties mentioned in bold type are individually inventoried resources**

- Recommended for listing in the National Register of Historic Places. If checked, you must attach a completed National Register Criteria Statement Form.
-

Massachusetts Historical Commission

Community
Property Address

Groton
79 Schoolhouse Road

Massachusetts Archives Building
220 Morrissey Boulevard
Boston, Massachusetts 02125

Area(s)

Form No

National Register of Historic Places Criteria Statement Form

Check all that apply:

Individually eligible X

Eligible only in a historic district

Contributing to a potential historic district

Potential historic district

Criteria: A B C D

Criteria considerations: A B C D E F G

Statement of significance by: Sanford Johnson

The criteria that are checked in the above sections must be justified here.

The Victorian Eclectic style Gale Farm at 79 Schoolhouse Road is potentially eligible for the National Register of Historic Places at the local level. The house and barn appear to have been built c. 1890 and the 1930 Groton map depicted it as the home of F. W. Gale. This is Frederick W. Gale, a laborer listed in the 1929 resident directory as living with his farmer parents Fred B. and Clemma Gale who had lived here since at least 1918. By 1939, the property was still in use as a farm and the land planted in hay and crops. The building's associations with historic agricultural activity in Groton establish its significance under Criterion A. The Victorian trim on the small house and large barn make the property eligible under Criterion C. The house and barn retain integrity of design, materials, setting and workmanship.

INVENTORY FORM CONTINUATION SHEET

Town
Groton

Property Address

Massachusetts Historical Commission
220 Morrissey Boulevard
Massachusetts Archives Building
Boston, MA 02125

Photos Taken 3-6/08

Area(s)
Form No.



79 Schoolhouse Rd



79 Schoolhouse Rd