

FORM B - Building

**Massachusetts Historical Commission
Massachusetts Archives Building
220 Morrissey Boulevard
Boston, Massachusetts 02125**

Map and Lot # **USGS Quad** **Area(s)** **Form Number**
116 10 568

Town **Groton3**
Place (neighborhood or village)
LA

Photograph

(3"x3" or 3-1/2x5" black and white only) Label photo on back with town and property address. Record film roll and negative numbers here on form. Staple photo to left side of form over this space. Attach additional photos to continuation sheets.

Roll Negative(s)

Address **11 Powderhouse Road**
Historic Name **F. G. Lawrence House**
Uses: Present **Dormitory**
Original **Residential**
Date of Construction **c. 1908**

Source **Previous Research**
Style/Form **Colonial Revival**

Architect/Builder

Exterior Material:

Foundation **Split granite**

Wall/Trim **Wood clapboard**

Roof **Asphalt shingle**

Outbuildings/secondary structure

Major Alterations (with dates)

Rear addition, 1961

Sketch Map

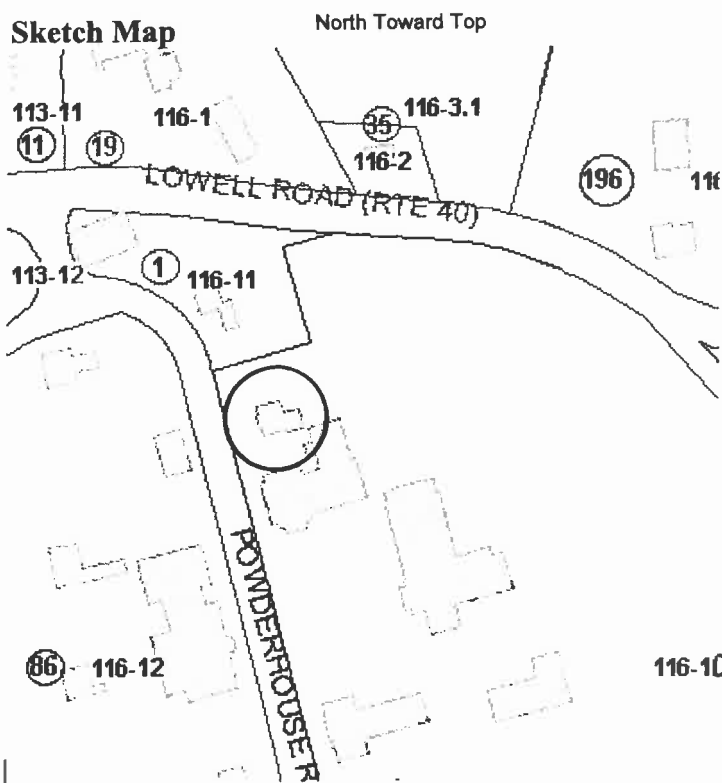

Recorded by **Sanford Johnson**

Organization **Groton Historical Commission**

Date (month/year) **12/08**

116-10 Condition **Excellent**

Moved no yes Date

Acreage **Part of LA campus**

Setting **Private school campus**

Follow Massachusetts Historical Commission Survey Manual instructions for completing this form.

BUILDING FORM

ARCHITECTURAL DESCRIPTION

see continuation sheet

Describe architectural features. Evaluate the characteristics of this building in terms of other buildings within the community.

- * The house at 11 Powderhouse Road is a foursquare form, Classical Revival style house with deck-hipped roof and open front porch; a gabled pavilion expands the plan at the center of the façade; a shed roofed addition of 2 stories has been made to the rear elevation
- * Decorative features include the modillions at the cornice and dentils in the pediment of the pavilion and porch cornice; grouped Doric columns support the front porch
- * Windows are mainly 2/1 double-hung sash except for the oculus with tracery and keystone ornament in the pediment of the pavilion
- * The center entry has 1/2 length sidelights
- * The setting is at the edge of the Lawrence Academy campus and has a rearward view of Gibbet Hill; the design is similar in scale and detail to the house at 17 School Street

HISTORICAL NARRATIVE

see continuation sheets

Discuss the history of the building. Explain its associations with local (or state) history. Include uses of the building, and the role(s) the owners /occupants played within the community.

The Frank G. (also spelled Francis J. Lawrence) Lawrence House was built in 1908 for Mr. Lawrence. It was purchased in 1925 by the trustees of the academy and leased to Carl A. P. Lawrence, LA class of 1910, Vice President of the Groton Leatherboard Company in West Groton, school business assistant and trustee from 1954-1973. It was used as a boys' dorm starting in 1959. The house was enlarged in 1961 and was put to use as a girls' dormitory in 1972.

BIBLIOGRAPHY and/or REFERENCES

continuation sheet

"Groton Houses", p. 172; "The History of Lawrence Academy at Groton 1792-1992", pp. 208, 241, 242, 252, 296,321, 324,364, 367, 398, 403; "Academy Day, Groton Days", p. 399; Stone, Orra. "History of Massachusetts Industries", p. 691. Boston, Chicago: S. J. Clarke Publishing Co., 1930. Available at the Massachusetts State Library

**** All properties mentioned in bold type are individually inventoried resources**

- Recommended for listing in the National Register of Historic Places. If checked, you must attach a completed National Register Criteria Statement Form.
-

INVENTORY FORM CONTINUATION SHEET

Town
Groton

Property Address

Massachusetts Historical Commission
220 Morrissey Boulevard
Massachusetts Archives Building
Boston, MA 02125

Photos Taken 3-6/08

Area(s)
Form No.



11 Powderhouse Rd, Lawrence House, Lawrence Academy