

# FORM B - Building

Massachusetts Historical Commission  
Massachusetts Archives Building  
220 Morrissey Boulevard  
Boston, Massachusetts 02125

Map and Lot # 112 37 USGS Quad Y Area(s) Form Number 384

Town Groton Center  
Place (neighborhood or village) Groton Center

## Photograph

(3"x3" or 3-1/2x5" black and white only) Label photo on back with town and property address. Record film roll and negative numbers here on form. Staple photo to left side of form over this space. Attach additional photos to continuation sheets.

Roll Negative(s)

## Sketch Map

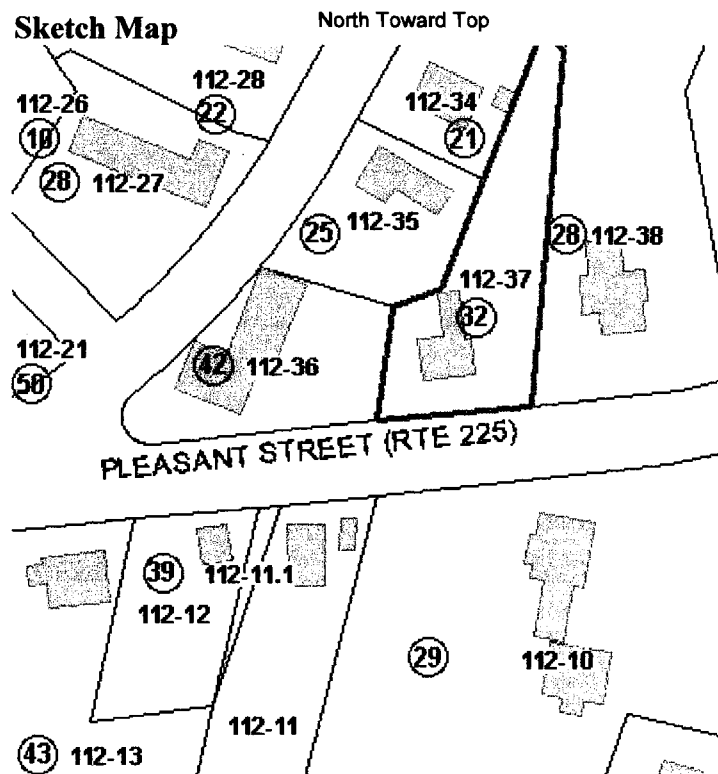

Recorded by Sanford Johnson

Organization Groton Historical Commission

Date (month/year) 12/07

Address 32 Pleasant Street

Historic Name

Uses: Present Residential

Original Residential

Date of Construction c. 1850

Source 1856 Walling map

Style/Form Greek Revival-Victorian Eclectic

Architect/Builder

Exterior Material:

Foundation Split granite

Wall/Trim Wood clapboard

Roof Asphalt shingle

Outbuildings/secondary structure

Major Alterations (with dates)

Condition Good

Moved no  yes  Date

Acreage .298

Setting Town Center

Follow Massachusetts Historical Commission Survey Manual instructions for completing this form.

## BUILDING FORM

### ARCHITECTURAL DESCRIPTION

see continuation sheet

*Describe architectural features. Evaluate the characteristics of this building in terms of other buildings within the community.*

- \* The house at 32 Pleasant Street is a front-gabled, 5x4-bay, design with elements of the Greek Revival and Victorian Eclectic styles; A 1-story rear addition is set perpendicular to the road; a hipped 1-story open porch is attached to the west side elevation
- \* Decorative features include the nearly symmetrical fenestration in the façade, molded cornice, corner boards, gable returns and Italianate style entry hood
- \* Windows are 6/6 double-hung sash with plain trim; the center entry has pilasters and a transom under the bracketed hood
- \* Two tall brick chimneys rise from each slope in the rear of the main roof
- \* The house is in good condition and is one of a small number of front-gabled Greek Revival style houses; Others exists at 31 Hollis Street and 2 Farmers Row

### HISTORICAL NARRATIVE

see continuation sheets

*Discuss the history of the building. Explain its associations with local (or state) history. Include uses of the building, and the role(s) the owners /occupants played within the community.*

The house at 32 Pleasant Street appears from the 1856 map to have been built for S. Farnsworth. By 1875, the owner was T. S. Farnsworth who lived here until at least 1889. This may be the man referred to in Dr. Green's town history as Thomas Spencer Farnsworth who married Harriet Lawton of Concord in 1835. Thomas appears in the 1865 census as a painter living on Pleasant Street with Harriet and three children. The house is depicted with an attached barn on the 1921 Sanborn map. The 1930 owners were Claribell and Ella Vickery.

### BIBLIOGRAPHY and/or REFERENCES

continuation sheet

1856 Walling map of Middlesex County; 1875 Beers atlas; 1889 Walker atlas; 1832 and 1847 Butler maps; Butler's 1829 field notes; 1939 WPA map; Federal census agricultural schedules, 1850-1880; Previous GHC Research; 1896, 1921 Sanborn Fire Insurance map; Resident Directories, 1918, 1929; Butler's town history; May, "Groton Plantation", p. 77; Butler's town history; Dr. Green, Vol iv, p. 240; 1930 Somes Map; 1855, 1865 state census;

**\*\* All properties mentioned in bold type are individually inventoried resources**

- Recommended for listing in the National Register of Historic Places. If checked, you must attach a completed National Register Criteria Statement Form.
-

**INVENTORY FORM CONTINUATION SHEET**

Massachusetts Historical Commission  
220 Morrissey Boulevard  
Boston, MA 02125

**Town**  
Groton

**Property Address**

**Area(s)**

**Form No.**



32 Pleasant Street