

# FORM B - Building

Massachusetts Historical Commission  
Massachusetts Archives Building  
220 Morrissey Boulevard  
Boston, Massachusetts 02125

Map and Lot # 102-50 USGS Quad Area(s) Form Number 457

Town Groton  
Place (neighborhood or village)

## Photograph

(3"x3" or 3-1/2x5" black and white only) Label photo on back with town and property address. Record film roll and negative numbers here on form. Staple photo to left side of form over this space. Attach additional photos to continuation sheets.

Roll Negative(s)

Address 107 Pepperell Road  
Historic Name  
Uses: Present Residential  
Original Residential  
Date of Construction c. 1890

Source Estimate  
Style/Form Victorian Eclectic

Architect/Builder  
Exterior Material:  
Foundation Unknown  
Wall/Trim Wood clapboard  
Roof Asphalt shingle  
Outbuildings/secondary structure  
2 detached sheds

Major Alterations (with dates)

Condition Good  
Moved no  yes  Date  
Acreage 1.25  
Setting Rural

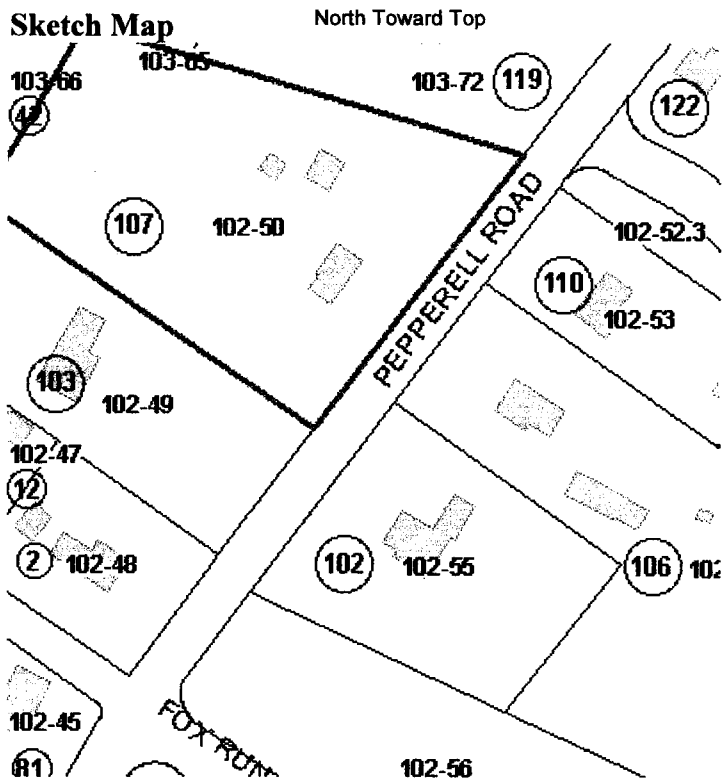

Recorded by Sanford Johnson

Organization Groton Historical Commission

Date (month/year) 12/07

Follow Massachusetts Historical Commission Survey Manual instructions for completing this form.

## BUILDING FORM

### ARCHITECTURAL DESCRIPTION

see continuation sheet

*Describe architectural features. Evaluate the characteristics of this building in terms of other buildings within the community.*

- \* The house at 107 Pepperell Road is a Victorian Eclectic style, 2 1/2-story, side-gabled, 5x2-bay form with a 1-story hip-roofed ell added to the northeast elevation
- \* Decorative elements are the gable returns, corner boards with molded caps, symmetrical fenestration in the façade and molded cornice
- \* Windows are 6/6 double-hung sash with plain trim and hood moldings except those in the ell which has 2/2 sash
- \* The center entry has sidelights and simple trim under a pedimented hood with cornice and segmental arched ceiling supported by thin Doric columns
- \* A single brick chimney rises from the rear slope of the roof
- \* The 2-bay front-gabled garage in the north side yard is clad in wood clapboards; Windows are 6/6 sash; Decorative features are the Colonial Revival style gable returns and molded cornice
- \* A second shed-sided outbuilding is visible behind the garage
- \* The setting is elevated slightly above this segment of Pepperell Road

### HISTORICAL NARRATIVE

see continuation sheets

*Discuss the history of the building. Explain its associations with local (or state) history. Include uses of the building, and the role(s) the owners /occupants played within the community.*

The house at 107 Pepperell Road does not appear on historic maps before 1889, suggesting the house was constructed subsequently. The 1930 owner may have been the farmer William V. Bixby. The land was in use as pasture, hayfields and timber land in 1939.

### BIBLIOGRAPHY and/or REFERENCES

continuation sheet

1856 Walling map of Middlesex County; 1875 Beers atlas; 1889 Walker atlas; 1832 and 1847 Butler maps; Butler's 1829 field notes; 1939 WPA map; Federal census agricultural schedules, 1850-1880; Previous GHC Research; 1896, 1921 Sanborn Fire Insurance map; Resident Directories, 1918, 1929; Butler's town history; May, "Groton Plantation", Butler's town history; 1930 Somes Map;

**\*\* All properties mentioned in bold type are individually inventoried resources**

- Recommended for listing in the National Register of Historic Places. If checked, you must attach a completed National Register Criteria Statement Form.
-

**INVENTORY FORM CONTINUATION SHEET**

**Town**  
Groton

**Property Address**

Massachusetts Historical Commission  
220 Morrissey Boulevard  
Boston, MA 02125

**Area(s)**

**Form No.**



107 Pepperell Road