

FORM B - Building

Massachusetts Historical Commission
Massachusetts Archives Building
220 Morrissey Boulevard
Boston, Massachusetts 02125

Map and Lot # USGS Quad Area(s) Form Number
103 7 118

Town Groton

Place (neighborhood or village)

Photograph

(3"x3" or 3-1/2"x5" black and white only) Label photo on back with town and property address. Record film roll and negative numbers here on form. Staple photo to left side of form over this space. Attach additional photos to continuation sheets.

Roll Negative(s)

Address 166 Kemp Street

Historic Name Moses Kemp House

Uses: Present Residential

Original Residential

Date of Construction 1782

Source Date carved in beam (GHS note)

Style/Form Federal

Architect/Builder

Exterior Material:

Foundation Granite

Wall/Trim Wood clapboard

Roof Asphalt shingle

Outbuildings/secondary structure

Attached modern garage

Major Alterations (with dates)

1-story gabled addition, c. 1900; front porch removed, late 20th c.

Condition Good

Moved no ☒ yes ☐ Date

Acreage 1

Setting Rural

Sketch Map

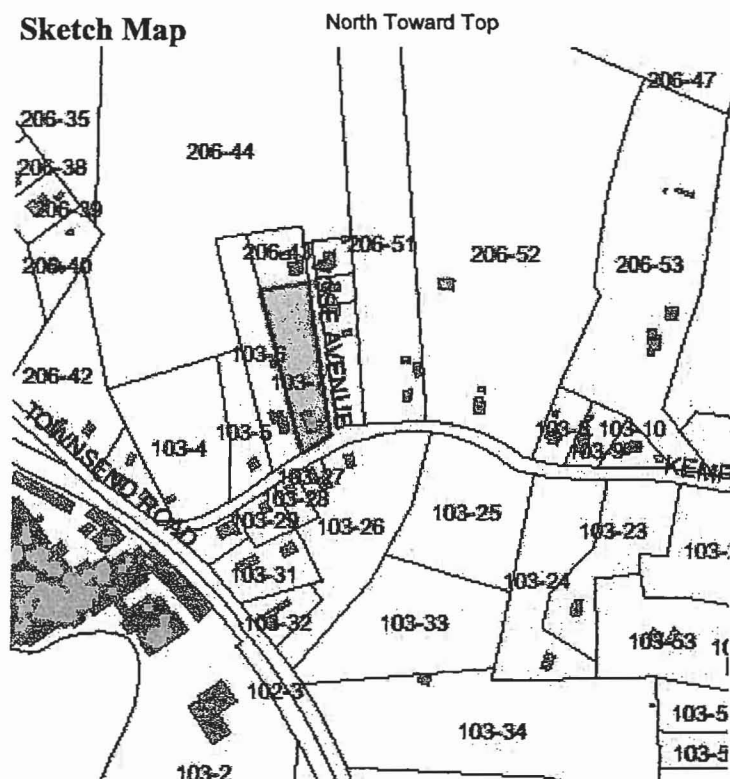

Recorded by Sanford Johnson

Organization Groton Historical Commission

Date (month/year) 6/06

Follow Massachusetts Historical Commission Survey Manual instructions for completing this form.

BUILDING FORM

ARCHITECTURAL DESCRIPTION

☐ see continuation sheet

Describe architectural features. Evaluate the characteristics of this building in terms of other buildings within the community.

- * The house at 166 Kemp Street is a Federal style, 2 1/2-story, side-gabled, 5x2-bay form
- * Decorative elements are the gable returns, corner boards, symmetrical fenestration in the façade and molded cornice
- * Windows are 6/6 double-hung sash with plain trim
- * The center entry has sidelights and simple trim, probably installed during the 20th century
- * Evidence of the previously existing front porch includes the concrete pad in the front yard
- * The small gabled addition to the south side elevation is clad in wood shingles and is approximately 10'x10'; the modern 2-bay garage is clad in wood clapboards
- * A stout brick chimney with corbelled cap rises from the center of the roof ridge
- * The setting is amid a wooded lot in a rural section of the town

HISTORICAL NARRATIVE

☐ see continuation sheets

Discuss the history of the building. Explain its associations with local (or state) history. Include uses of the building, and the role(s) the owners /occupants played within the community.

The first known owner of 166 Kemp Street was Moses Kemp, owner in 1830 of property valued at \$1,800, an average amount for a farm in Groton. GHS researchers record that a beam inside is marked "MK 1782", possibly referring to the date Moses Kemp built the house. He is said by the GHS to have played the fife in the war of 1812. Butler's field notes from 1828-29 describe an old house with the existing form. By 1847, the owner depicted on the Butler map was R. Patch who, listed as Ralph Patch in tax records, paid tax on a farm valued at \$1,000. By 1856, the farm had reverted to the Kemp family under ownership of the farmer James Kemp and his wife Amanda. The 1875 atlas indicates the wealthy industrialist Lyman Hollingsworth to be the owner. Mr. Hollingsworth resided in Boston but owned 10 houses in town as well as mills on the Squannacook River at the current site of the Hollingsworth and Vose paper mill on Townsend Road. The ten houses he owned were likely in use as employee housing. The Boston resident directory for 1875 lists Lyman Hollingsworth (employed at B. H. Thayer & Co., 75 Federal Street) as living in a house at 58 Commonwealth Avenue. Also, he is listed as a partner in the firm, L. Hollingsworth & Co., with his partner William T. Parker, (paper manufacturers) at 75 Federal Street and presumably, with a satellite operation in Groton at Main Street and Nod Road and in West Groton as shown on maps from 1856, 1875 and 1889. Five additional Hollingsworth family members are also listed as working in the paper industry, mostly on Federal Street. The 1930 map of Groton indicates the house was owned by Daniel Ludden, a paper maker in West Groton according to the 1929 resident directory.

BIBLIOGRAPHY and/or REFERENCES

☐ continuation sheet

1832, 1847 Butler maps and field notes; 1875 Beers Atlas; 1856 Walling map of Middlesex County; Previous GHS research; 1929 resident directory; 1939 WPA map; 1889 Walker atlas; Tax records, 1830-1889; 1855, 1865 state census; Boston resident directory, 1875; 1930 map of Groton;

**** All properties mentioned in bold type are individually inventoried resources**

- ☐ Recommended for listing in the National Register of Historic Places. If checked, you must attach a completed National Register Criteria Statement Form.
-

INVENTORY FORM CONTINUATION SHEET

Massachusetts Historical Commission
220 Morrissey Boulevard
Massachusetts Archives Building
Boston, Massachusetts 02125

Town
Groton

Property Address

Area(s)

Form No.

166 Kemp Street

