

FORM B - Building

Massachusetts Historical Commission
Massachusetts Archives Building
220 Morrissey Boulevard
Boston, Massachusetts 02125

Map and Lot # USGS Quad Area(s) Form Number
236 20 55

Town Groton

Place (neighborhood or village)

Photograph

(3"x3" or 3-1/2x5" black and white only) Label photo on back with town and property address. Record film roll and negative numbers here on form. Staple photo to left side of form over this space. Attach additional photos to continuation sheets.

Roll Negative(s)

Sketch Map

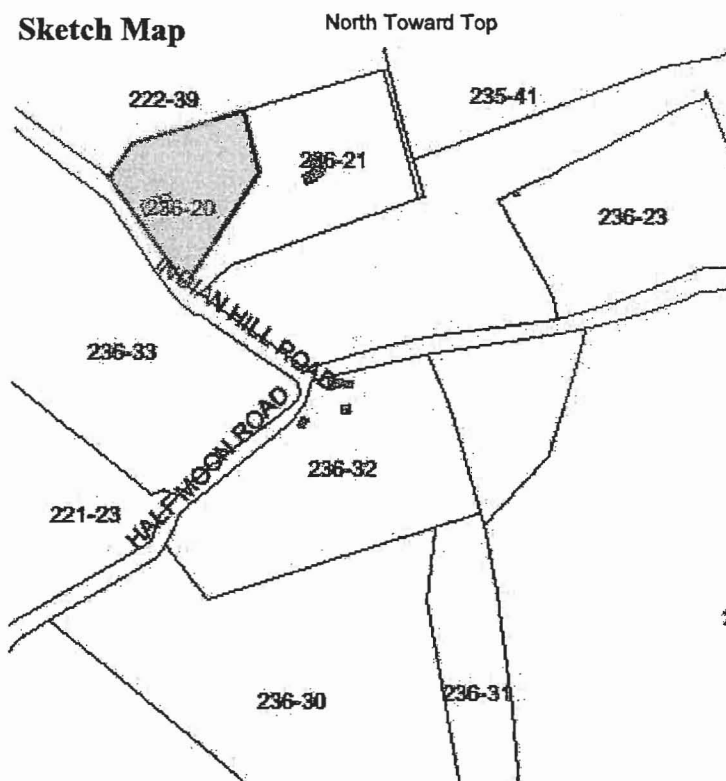

Recorded by Sanford Johnson

Organization Groton Historical Commission

Date (month/year) 6/06

Address 205 Indian Hill Road

Historic Name Farnsworth, Asahel House

Uses: Present Residential

Original Residential- agricultural

Date of Construction c. 1825

Source 1832 Butler map

Style/Form Federal, Victorian Eclectic

Architect/Builder

Exterior Material:

Foundation Fieldstone

Wall/Trim Wood clapboard

Roof Asphalt shingle

Outbuildings/secondary structure

Major Alterations (with dates)

East section enlarged or rebuilt, c. 1840; Side gabled front addition, c. 1840;

Condition Good

Moved no ☒ yes ☐ Date

Acreage 3.01

Setting Rural

Follow Massachusetts Historical Commission Survey Manual instructions for completing this form.

BUILDING FORM

ARCHITECTURAL DESCRIPTION

☐ see continuation sheet

Describe architectural features. Evaluate the characteristics of this building in terms of other buildings within the community.

- * The house at 205 Indian Hill Road is comprised of a side-gabled Federal style block five bays in width and 2 1/2 stories high oriented southeast; this is enlarged by a perpendicular side-gabled, 2 1/2-story, 5x2-bay block of similar scale with Victorian detail oriented southwest; a 1-story gabled garage is attached to the east side of the Federal style block
- * Details on the Federal part of the house include the symmetrical fenestration in the façade, molded cornice and corner boards as well as a classical surround at the center entry that includes an entablature, sidelights and pilasters; ornament on the Victorian section consists of deep eaves, gable returns, corner boards and the molded cornice
- * Windows in the Federal block are 6/6 double hung sash with slim hoods; those in the Victorian section are 6/6 in the second story and modern sliding glass doors on the first
- * A brick chimney occupies the ridge of each section of the house
- * The house occupies a parcel surrounded by open land
- * The Federal style section retains most design features and is in good condition

HISTORICAL NARRATIVE

☐ see continuation sheets

Discuss the history of the building. Explain its associations with local (or state) history. Include uses of the building, and the role(s) the owners /occupants played within the community.

The house at 205 Indian Hill Road was built sometime prior to publication of the 1832 Butler map of Groton which depicts Asahel Farnsworth as the occupant. Butler's field notes from 1828-29 describe an old house that was only three bays across the façade, suggesting the house was enlarged or rebuilt shortly after that time. Tax records from 1830 show he owned a farm valued at \$2,000, an average amount for a farm in Groton. Subsequent owners were Charles Prescott in 1847 who was taxed for a farm valued at \$3,000, an increase that may suggest the construction of the c. 1840 addition to the original Federal style block. Census schedules from 1855 list Mr. Prescott as a 45 year-old farmer. D. Livermore appears as the owner on the 1856 Walling map, a name that is confirmed in the state census from 1855 which lists Daniel Livermore as a farmer living with his wife Abigail, four children and two elderly women, also named Livermore; in 1865 he was listed with his wife and 6 children, the two youngest of whom were born in Kansas which suggests the Livermores may have emigrated temporarily to the Midwest in order to vote against the expansion of slavery as did other New Englanders associated with the New England Emigrant Aid Society. Their numbers were sufficient to found the city of Lawrence Kansas which was named for Groton native and abolitionist Amos Lawrence. Thomas Clark was the owner in 1875 and Jerome H. Sawyer in 1889, both of whom were farmers who owned 118 acres. Gerard Connolly appears as the owner in 1930. The WPA map of 1939 depicts the property as a farm with pasture, crops and timber under cultivation.

BIBLIOGRAPHY and/or REFERENCES

☐ continuation sheet

1832, 1847 Butler maps and field notes; 1875 Beers Atlas; 1856 Walling map of Middlesex County; Previous GHS research; 1929 resident directory; 1939 WPA map; 1889 Walker atlas; Tax records, 1830-1889; 1855, 1865 state census;

**** All properties mentioned in bold type are individually inventoried resources**

- ☐ Recommended for listing in the National Register of Historic Places. If checked, you must attach a completed National Register Criteria Statement Form.
-

INVENTORY FORM CONTINUATION SHEET

Massachusetts Historical Commission
220 Morrissey Boulevard
Massachusetts Archives Building
Boston, Massachusetts 02125

Town
Groton

Property Address

Area(s)

Form No.

205 Indian Hill Road

