

FORM B - Building

**Massachusetts Historical Commission
 Massachusetts Archives Building
 220 Morrissey Boulevard
 Boston, Massachusetts 02125**

Map and Lot # 112 35 USGS Quad Area(s) Y Form Number 107

Town Groton Center
 Place (neighborhood or village) Groton Center

Photograph

(3"x3" or 3-1/2x5" black and white only) Label photo on back with town and property address. Record film roll and negative numbers here on form. Staple photo to left side of form over this space. Attach additional photos to continuation sheets.

Roll Negative(s)

Address 25 Elm Street
 Historic Name
 Uses: Present Residential
 Original Residential
 Date of Construction c. 1820
 Source Estimate

Style/Form Cape Cod
 Architect/Builder
 Exterior Material:
 Foundation Split granite
 Wall/Trim Wood clapboard
 Roof Asphalt shingle
 Outbuildings/secondary structure

Major Alterations (with dates)

Condition Fair
 Moved no yes Date
 Acreage .25
 Setting Town Center

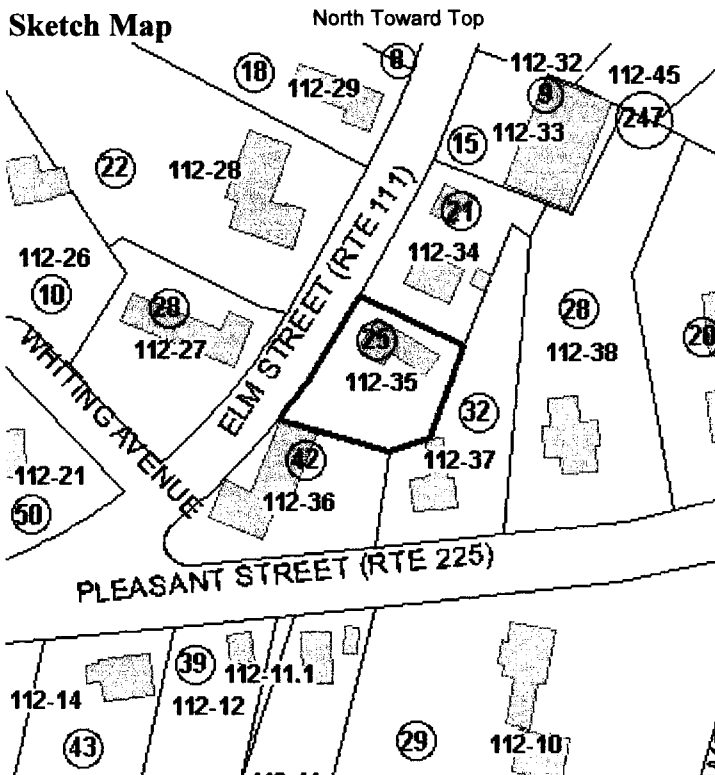

Recorded by Sanford Johnson
 Organization Groton Historical Commission
 Date (month/year) 12/07

BUILDING FORM

ARCHITECTURAL DESCRIPTION

see continuation sheet

Describe architectural features. Evaluate the characteristics of this building in terms of other buildings within the community.

- * The diminutive house at 25 Elm Street is a Cape Cod form of 1 story built on a 3x2 bay plan with a 1-story rear ell
- * Decorative features include the corner boards and the symmetrical fenestration in the façade
- * Windows are 6/9 double-hung sash with plain trim
- * The center entry also has plain trim
- * A low brick chimney occupies the roof ridge
- * The house is in fair condition but appears to retain most of its historic features and fabric
- * The house is much smaller than others on Elm Street and in Groton Center in general

HISTORICAL NARRATIVE

see continuation sheets

Discuss the history of the building. Explain its associations with local (or state) history. Include uses of the building, and the role(s) the owners /occupants played within the community.

The owner of the house on Butler's map of 1832 appears to have been the Widow Lewis about whom little else is known. By 1847, the name associated with the property is J. Balcom and later, in 1875 and 1889, Mrs. Woodcock. The small size of the house suggests the owners were of limited means and therefore do not appear in town histories that deal mainly with persons of note. On the 1921 Sanborn Fire Insurance map, the house appears in its current configuration. The owner from c. 1918-c. 1930 was Mary L. Hutchins.

BIBLIOGRAPHY and/or REFERENCES

continuation sheet

1856 Walling map of Middlesex County; 1875 Beers atlas; 1889 Walker atlas; 1832 and 1847 Butler maps; 1939 WPA map; Butler's 1829 field notes; Federal census agricultural schedules, 1850-1880; Previous GHC Research; 1921 Sanborn Fire Insurance map; Resident Directories, 1918, 1929; 1930 Somes map; Resident directories;

**** All properties mentioned in bold type are individually inventoried resources**

- Recommended for listing in the National Register of Historic Places. If checked, you must attach a completed National Register Criteria Statement Form.
-

INVENTORY FORM CONTINUATION SHEET

Town
Groton

Property Address

Massachusetts Historical Commission
220 Morrissey Boulevard
Massachusetts Archives Building
Boston, MA 02125

Area(s)
Form No.



25 Elm Street