

# FORM B - Building

Massachusetts Historical Commission  
Massachusetts Archives Building  
220 Morrissey Boulevard  
Boston, Massachusetts 02125

Map and Lot # 225-22 USGS Quad Area(s) Form Number 498

Town Groton3  
Place (neighborhood or village)

## Photograph

(3"x3" or 3-1/2x5" black and white only) Label photo on back with town and property address. Record film roll and negative numbers here on form. Staple photo to left side of form over this space. Attach additional photos to continuation sheets.

Roll Negative(s)

Address 162 Common Street

Historic Name

Uses: Present Residential

Original Residential

Date of Construction c. 1890

Source Estimate

Style/Form Victorian Eclectic

Architect/Builder

Exterior Material:

Foundation Brick

Wall/Trim Wood clapboards

Roof Asphalt shingle

Outbuildings/secondary structure

Major Alterations (with dates)

Condition Good

Moved no  yes  Date

Acreage 28

Setting Rural

## Sketch Map

225-16  
110-32

North Toward Top

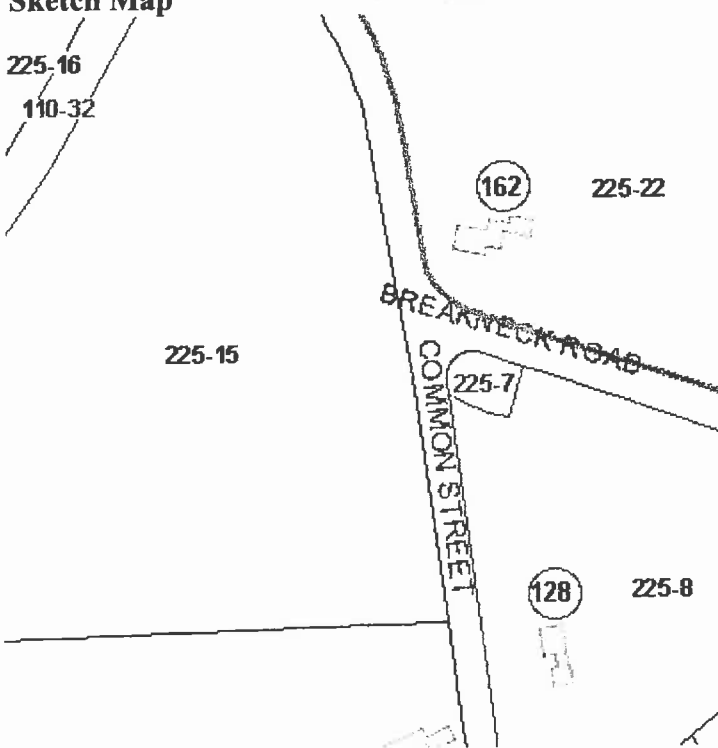

Recorded by Sanford Johnson

Organization Groton Historical Commission

Date (month/year) 12/08

Follow Massachusetts Historical Commission Survey Manual instructions for completing this form.

## BUILDING FORM

### ARCHITECTURAL DESCRIPTION

see continuation sheet

*Describe architectural features. Evaluate the characteristics of this building in terms of other buildings within the community.*

- \* The house at 162 Common Street is a Victorian Eclectic style, 3x2-bay, 2 1/2-story side gabled form with a rear ell and attached shed at the northeast corner; the center entry has an open flat roofed porch supported by square piers; the door is a double leaf arrangement lit by quarrel panes
- \* Decorative features include the corner boards with molded caps, gable returns, prominent window hoods and symmetrical fenestration pattern
- \* Windows are 2/2 double hung sash
- \* The design is relatively simple for a Victorian example, is well preserved and appears to retain most original materials and features

### HISTORICAL NARRATIVE

see continuation sheets

*Discuss the history of the building. Explain its associations with local (or state) history. Include uses of the building, and the role(s) the owners /occupants played within the community.*

The first known owner of 162 Common Street was Flora J. Smith (born c. 1878) whose occupancy is reflected on the 1930 map of Groton. Little else is known of the owner or the property.

### BIBLIOGRAPHY and/or REFERENCES

continuation sheet

Resident directories, 1918, 1929; 1930 Somes map of Groton; 1875, 1889 Middlesex County atlases; Federal census records

**\*\* All properties mentioned in bold type are individually inventoried resources**

- Recommended for listing in the National Register of Historic Places. If checked, you must attach a completed National Register Criteria Statement Form.
-

Massachusetts Historical Commission

Massachusetts Archives Building  
220 Morrissey Boulevard  
Boston, Massachusetts 02125

Community  
Property Address

Groton  
162 Common Street

Area(s)

Form No

### National Register of Historic Places Criteria Statement Form

Check all that apply:

Individually eligible  X

Eligible only in a historic district

Contributing to a potential historic district

Potential historic district

Criteria:                    A    B     C    D

Criteria considerations:    A    B    C    D    E    F    G

Statement of significance by: Sanford Johnson

*The criteria that are checked in the above sections must be justified here.*

The Victorian Eclectic Style house at 162 Common Street is potentially eligible for the National Register of Historic Places as an individual resource at the local level. The only known owner was Flora J. Smith whose name is associated with the property on the 1930 Somes map of Groton. The symmetrical fenestration, prominent corner boards with molded caps, gable returns, window hoods and entry porch are typical of style in Groton, making the property eligible under Criterion C. The house and barn retain integrity of design, materials, setting and workmanship.

**INVENTORY FORM CONTINUATION SHEET**

**Town**  
Groton

**Property Address**

Massachusetts Historical Commission  
220 Morrissey Boulevard  
Massachusetts Archives Building  
Boston, MA 02125

Photos Taken 3-6/08

**Area(s)**  
**Form No.**



162 Common St