

FORM B - Building

Massachusetts Historical Commission
Massachusetts Archives Building
220 Morrissey Boulevard
Boston, Massachusetts 02125

Map and Lot # 111-22 USGS Quad Area(s) Form Number 493

Town Groton3
Place (neighborhood or village)

Photograph

(3"x3" or 3-1/2x5" black and white only) Label photo on back with town and property address. Record film roll and negative numbers here on form. Staple photo to left side of form over this space. Attach additional photos to continuation sheets.

Roll Negative(s)

Sketch Map

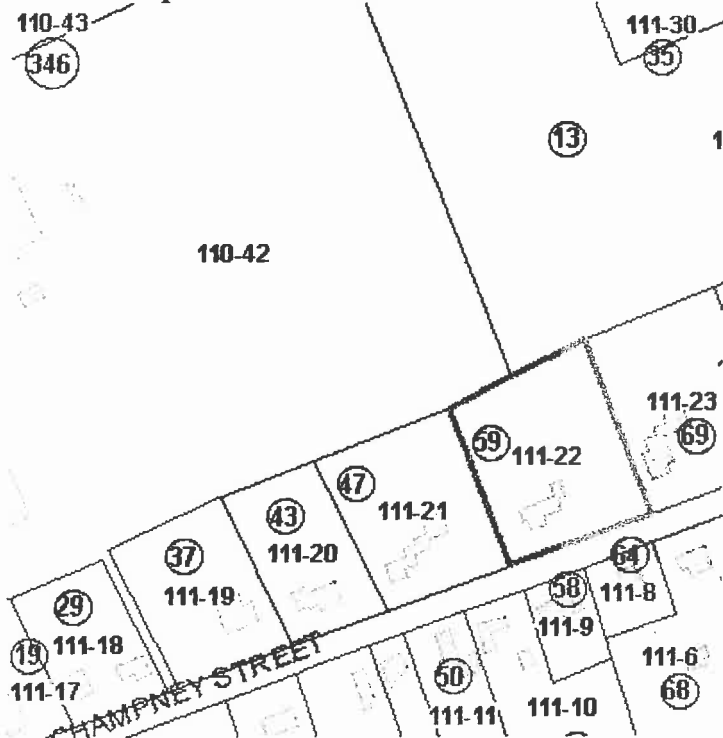

Address 59 Champney Street
Historic Name
Uses: Present Residential
Original Residential
Date of Construction c. 1890
Source Estimate
Style/Form Victorian Eclectic
Architect/Builder
Exterior Material:
Foundation Split granite, brick
Wall/Trim Wood clapboards
Roof Asphalt shingle
Outbuildings/secondary structure

Major Alterations (with dates)

Condition Excellent
Moved no yes Date
Acreage 1.2
Setting Rural, residential street

Recorded by Sanford Johnson

Organization Groton Historical Commission

Date (month/year) 12/08

Follow Massachusetts Historical Commission Survey Manual instructions for completing this form.

BUILDING FORM

ARCHITECTURAL DESCRIPTION

see continuation sheet

Describe architectural features. Evaluate the characteristics of this building in terms of other buildings within the community.

- * The house at 59 Champney Street is a 2 1/2-story, cross-gabled, 2x3-bay form with a lower 2 1/2-story ell at the northeast side, a 1 story attached shed east of that and elements of the Victorian Eclectic style; a 1-story open porch covers the side-hall entry and the first story of the 2 1/2-story ell
- * Ornament consists of the corner boards, closed gable, jigsaw brackets at the cornice of the porch and molded cornice
- * Windows are mainly 2/1 double-hung sash with plain trim and slim hoods; the window in the gable peak is a 6/1 configuration and the sash in the west end of the ell is a multiple pane fixed unit
- * The main side-hall entry has plain trim with a hood above and matches the secondary entry in the ell, both under the open porch
- * The attached shed has paired swinging doors
- * The house appears to retain most original materials and design features and is of a scale typical for Champney Street
- * The design is remarkably similar to the houses at 29, 47 and 43 Champney Street, suggesting they were built by the same builder

HISTORICAL NARRATIVE

see continuation sheets

Discuss the history of the building. Explain its associations with local (or state) history. Include uses of the building, and the role(s) the owners /occupants played within the community.

Champney Street was laid out shortly after publication of the 1889 atlas of Middlesex County. The owner of the house at 59 Champney Street on the 1930 map of Groton appears to be Marshall Swallow. Mr. Swallow worked as a carpenter and lived here with his wife Lura according to the 1929 resident directory. Mr. Swallow lived here as early as 1918 according to the resident directory from that year.

BIBLIOGRAPHY and/or REFERENCES

continuation sheet

Resident directories, 1918, 1929; 1930 Some map of Groton;

**** All properties mentioned in bold type are individually inventoried resources**

- Recommended for listing in the National Register of Historic Places. If checked, you must attach a completed National Register Criteria Statement Form.
-

INVENTORY FORM CONTINUATION SHEET

Town
Groton

Property Address

Massachusetts Historical Commission
220 Morrissey Boulevard
Massachusetts Archives Building
Boston, MA 02125

Photos Taken 3-6/08

Area(s)
Form No.



59 Champney St